

THE POLYSTYRENE - SYSTEM 300



Plastabrick provide for a BRANZ appraised Polystyrene system, that allows a 20mm cavity between the building paper (which is placed over the timber framing) and the polystyrene exterior sheeting.

SYSTEM 300 - TECHNICAL OVERVIEW

System 300 is a BRANZ appraised polystyrene cavity system (BRANZ appraisal no TP1123-EZ02), the products are also tested by OPUS International Consultants LTD (test no 169429.00) at their Auckland Laboratory to conform with the NZ building code and to NZS Standards.

System 300 is a Plastering System for external Polystyrene application comprising cement-based BREATHABLE mineral plasters, alkaline resistant fibreglass mesh and assorted PVC flashings and trims. The Polystyrene sheets are mechanically fixed to exterior framing or bonded directly onto concrete or masonry services.

System 300 is a three-coat plaster system incorporating embedded fibreglass reinforcing mesh and selected finish coats. System 300 is also ideal for the plastering and weatherproofing requirements of Polystyrene block structures.

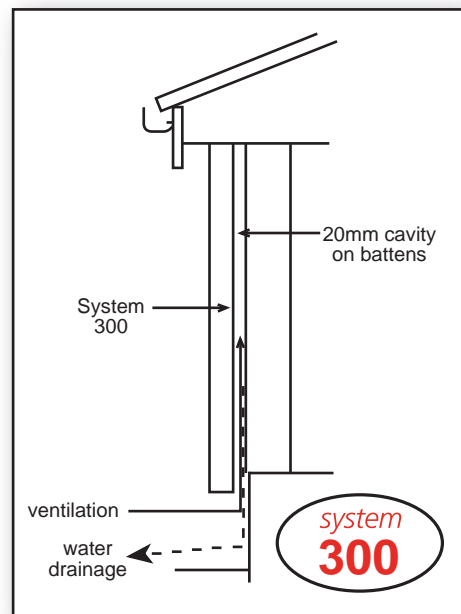

The main component of System 300 is PT300 plaster, which provides a tough, durable and crack resistant base coat when used in conjunction with fibreglass reinforcing mesh. (For further detailed information contact Plastabrick)

BUILDING REGULATIONS

System 300, when installed and maintained according to the instructions and procedures recommended by Putz-Technik Products Ltd, will meet the provisions of the New Zealand Building Code as required by: Clause B1 Structure: B2 Durability: E2 External Moisture: and H1 Energy Efficiency.