

The system with a 15 year guarantee

THE PLASTABRICK CLADDING SYSTEM

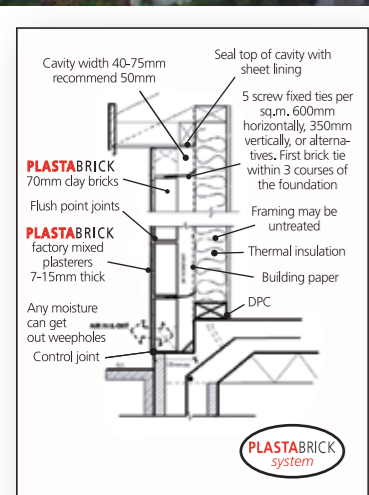
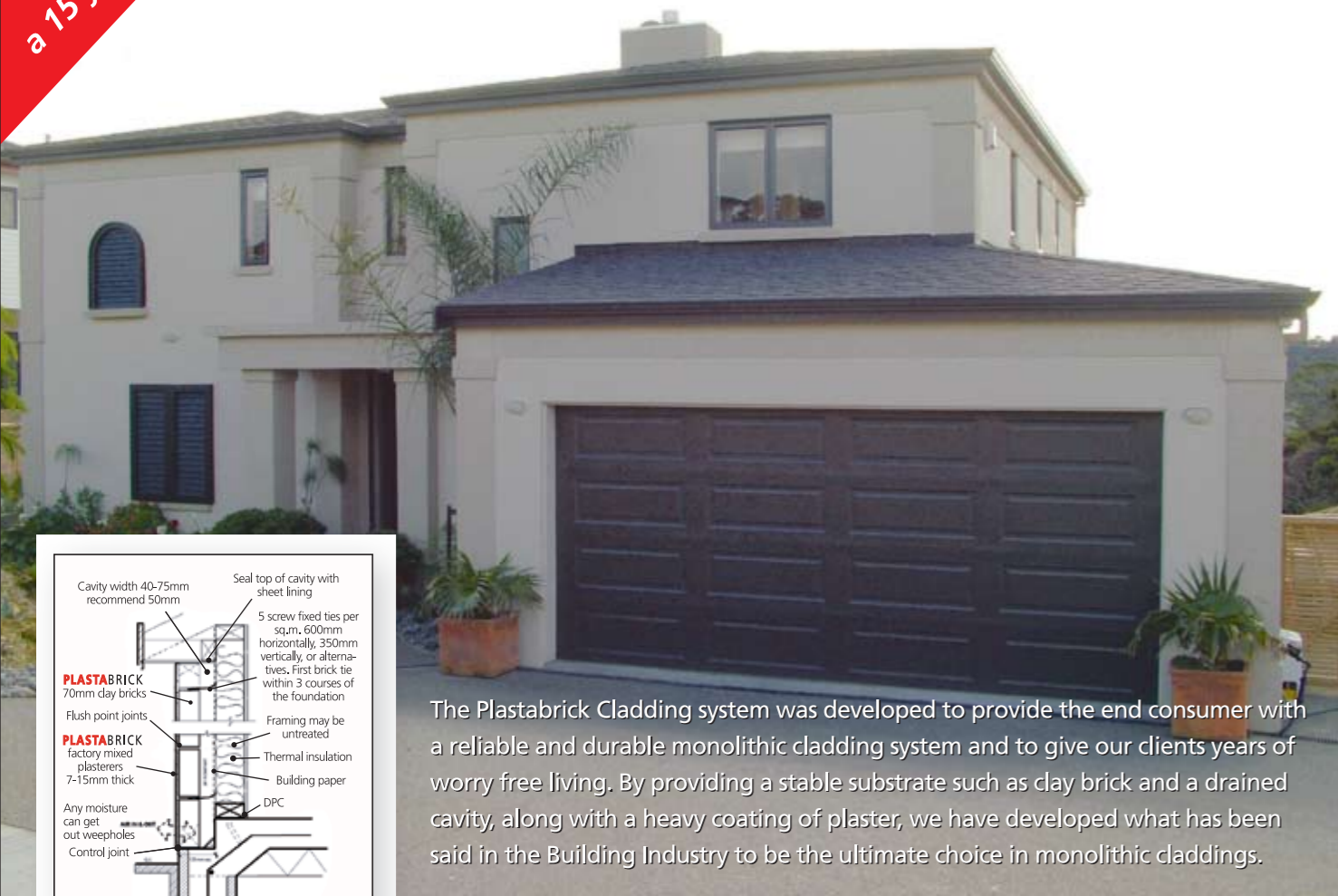

The Plastabrick Cladding system was developed to provide the end consumer with a reliable and durable monolithic cladding system and to give our clients years of worry free living. By providing a stable substrate such as clay brick and a drained cavity, along with a heavy coating of plaster, we have developed what has been said in the Building Industry to be the ultimate choice in monolithic claddings.

THE BRICKS

Plastabrick use a purpose made, dimensionally accurate high quality brick designed to be plastered over. The quality of the substrate is important to our company as it can impact on the plaster finish and its long term performance. This substrate does not require control joints as it is extremely stable – a very important point.

THE PLASTER

The plaster coatings we apply result in a finished thickness in the order of 10mm. Plastabrick have steered away from the thin coatings our competitors use and see benefit in traditional methods. The product is a mineral cement plaster produced to a European DIN Standard formula. It is mixed on site and hand trowelled onto the brick veneer. There is a range of finishes to satisfy most individuals; from the smooth to the adobe, the dragged to the stippled, we will endeavour to meet your needs. In practice, we prepare on site test walls to establish exactly the type of finish you require; this becomes our standard.

THE PAINT

Plastabrick only use top quality acrylic paints that completely waterproof the plaster coating. This system makes future cleaning of the surface a simple process.

THE WARRANTY

Plastabrick NZ Ltd stands behind their workmanship and product at every stage of the process and provide a 15 year Project Specific Warranty. In addition to the above features, specifying Plastabrick makes life easy for the builder as he is employing one company to provide a single coordinated service ensuring a smooth well run installation.

Important Note: Plastabrick does not necessarily have to provide the system in its full application. We can provide you with a licenced Plastabrick applicator who can apply the plaster coating over the already installed bricklaying, a 15 year warranty will still apply to the plaster coating.

THE POLYSTYRENE - SYSTEM 300



Plastabrick provide for a BRANZ tested Polystyrene system, that allows a 20mm cavity between the building paper and the polystyrene sheeting. With the use of System 300 it will not only cater for all those hard to get at areas on a Full Plastabrick house but it can be designed and installed to fulfil your needs on any type of house, be it two story, single level or a pop top type situation where only the second level on the house needs to be done in polystyrene. System 300 can also be used on unit or apartment type dwellings.

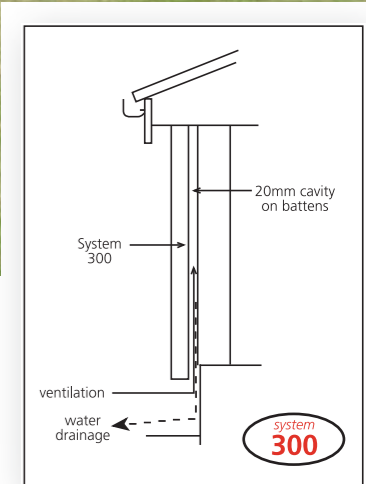

SYSTEM 300 - Technical Overview

System 300 is a BRANZ tested polystyrene cavity system (BRANZ test no TP1123-EZ02) the products are also tested by OPUS International Consultants LTD (test no 169429) at their Auckland Laboratory to conform with the NZ building code, NZ and European (DIN) standards.

System 300 is a Plastering System for external Polystyrene applications comprising cement-based BREATHABLE mineral plasters, alkaline resistant fibreglass mesh and assorted PVC flashing and trims. The Polystyrene sheets are mechanically fixed to exterior framing or bonded directly onto concrete or masonry services. System 300 is a three-coat plaster system incorporating embedded fibreglass reinforcing mesh and selected finish coats.

System 300 is also ideal for the plastering and weather-proofing requirements of Polystyrene block structures. The main component of System 300 is PT300 plaster, which provides a tough, durable and crack resistant base coat when used in conjunction with fibreglass reinforcing mesh.

Note: For further detailed information, contact Plastabrick.

Breakdown of the PLASTABRICK System 300

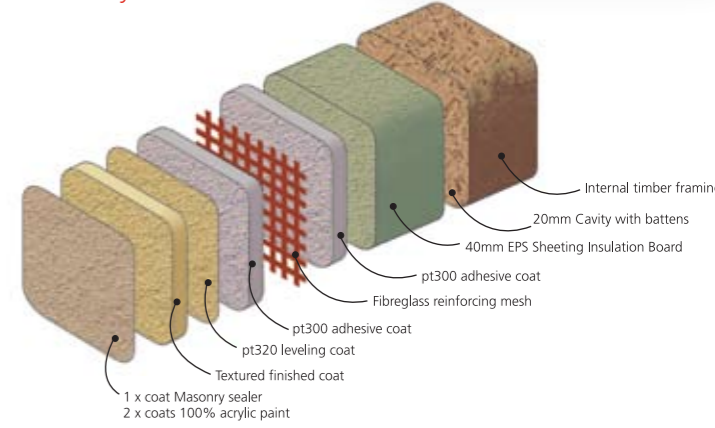

BUILDING REGULATIONS

System 300, when installed and maintained according to the instructions and procedures recommended by the manufacturer, will meet the provisions of the New Zealand Building Code as required by: Clause B1 Structure: B2 Durability: E2 External Moisture: and H1 Energy Efficiency.